



BOSCH COMMON RAIL

Chevy/GMC/Dodge/Freightliner/Mercedes

FUEL INJECTORS & HIGH PRESSURE CP3 PUMPS

Bostech sells only the highest quality common rail injectors. Each injector is completely remanufactured. The control valves for every injector are examined under a microscope to verify that they are flawless.

If the slightest flaw is identified, the control valve is replaced. After reassembly, each injector is thoroughly tested on our state of the art testing equipment.



CHEVY/GMC APPLICATION	ENGINE	OEM #	INJECTOR #	CP3 PUMP #	FUEL PRESSURE REGULATOR MPRM
2001-2004.5 SILVERADO/TOPKICK/KODIAK	6.6L VIN# 1, LB7	97729095	DE651 (4) (5) (6)	HPP7303	47728979
2004.5-2005 SILVERADO/TOPKICK/KODIAK	6.6L VIN# 2, LLY	97303657	DE665	HPP7308	97369850
2006-2007 SILVERADO/TOPKICK/KODIAK	6.6L VIN# D, LBZ	97361355	DE668	HPP7332	97384667
2006-2007 SILVERADO/TOPKICK/KODIAK	6.6L VIN# 2, LLY	97361355	DE668	HPP7308	97384667
2007-2010 SILVERADO/TOPKICK/KODIAK	6.6L VIN# 6, LMM	98002368	DE669	HPP7332	97384667
2011-2014 SILVERADO/TOPKICK/KODIAK	6.6L LML	19256590	DE670		
2011-2014 G-SERIES VAN	6.6L LGH	19210900	DE671		



DODGE TRUCK APPLICATION	ENGINE	OEM #	INJECTOR #	CP3 PUMP #	FUEL PRESSURE ACTUATOR
2007-2010 RAM PICKUP	6.7L (ALL)	68027067AA, R80270767AA	DE802 (3) **	HPP7334	68005241AA
2007-2010 CAB CHASSIS	6.7L (ALL)	R800201AB, 6700201AB, 4940096	DE803 (3)	HPP7334	68005241AA
2010-2012 CAB CHASSIS	6.7 (ALL)		DE808	HPP7334	
2004.5-2007 RAM	5.9L (ALL)	R5135790AD, 5135790AD	DE801 (2) *	HPP7304	5183245AA
2003-2004.5 RAM	5.9L (ALL)	5254686, 3949619, R8004082AA, 8004082AA	DE811 (2)	HPP7304	5183245AA



SPRINTER APPLICATION	ENGINE	OEM #	INJECTOR #	CP3 PUMP #
2000-2003 SPRINTER (FREIGHTLINER/DODGE/MERCEDES)	2.7L OM612	6120700387	DE852	HPP7016
2004-2006 SPRINTER (FREIGHTLINER/DODGE/MERCEDES)	2.7L OM647	6470700187	DE851	HPP7311
2007-2008 SPRINTER (FREIGHTLINER/DODGE/MERCEDES)	3.0L OM642	6420701587	DE850	

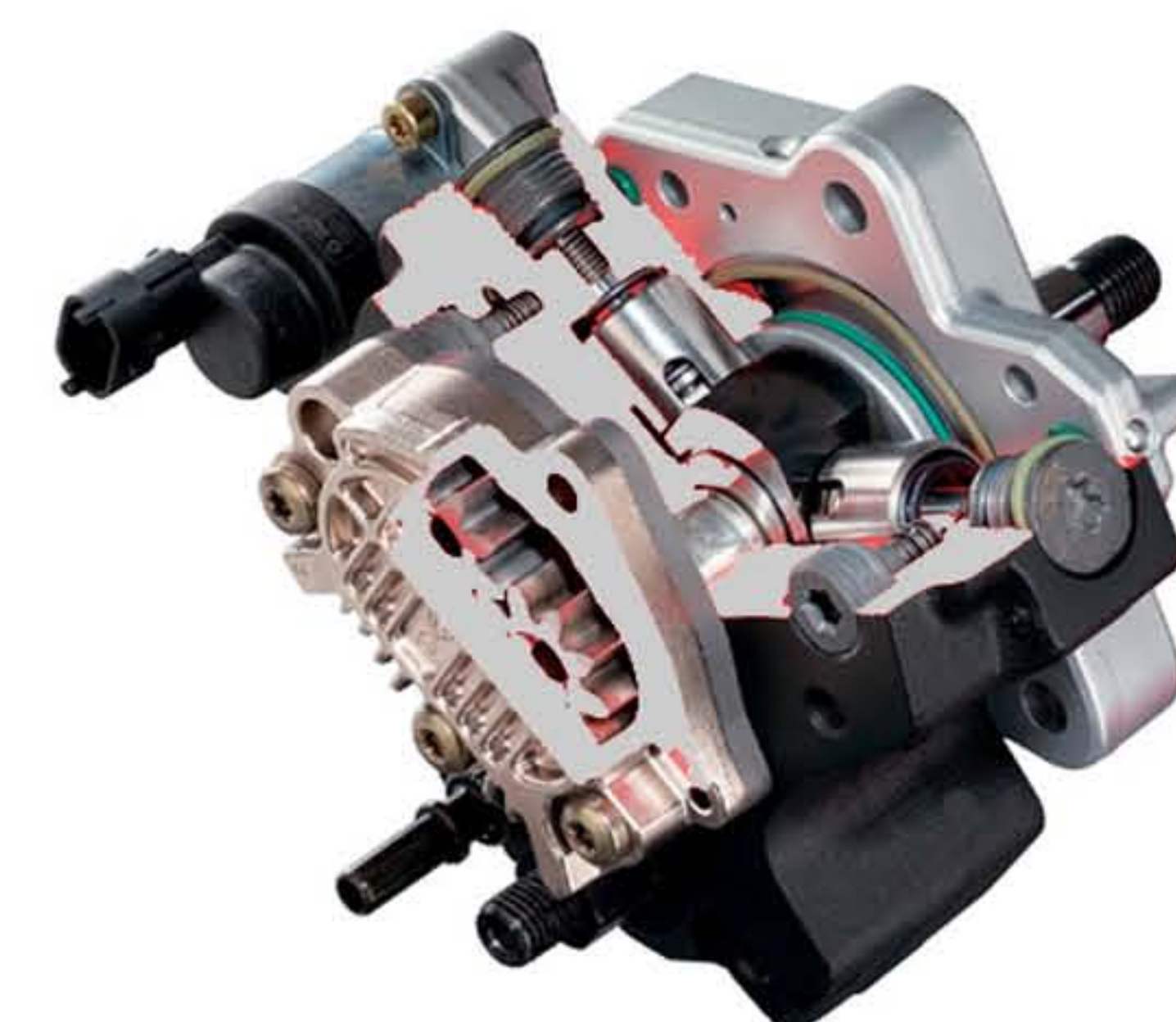
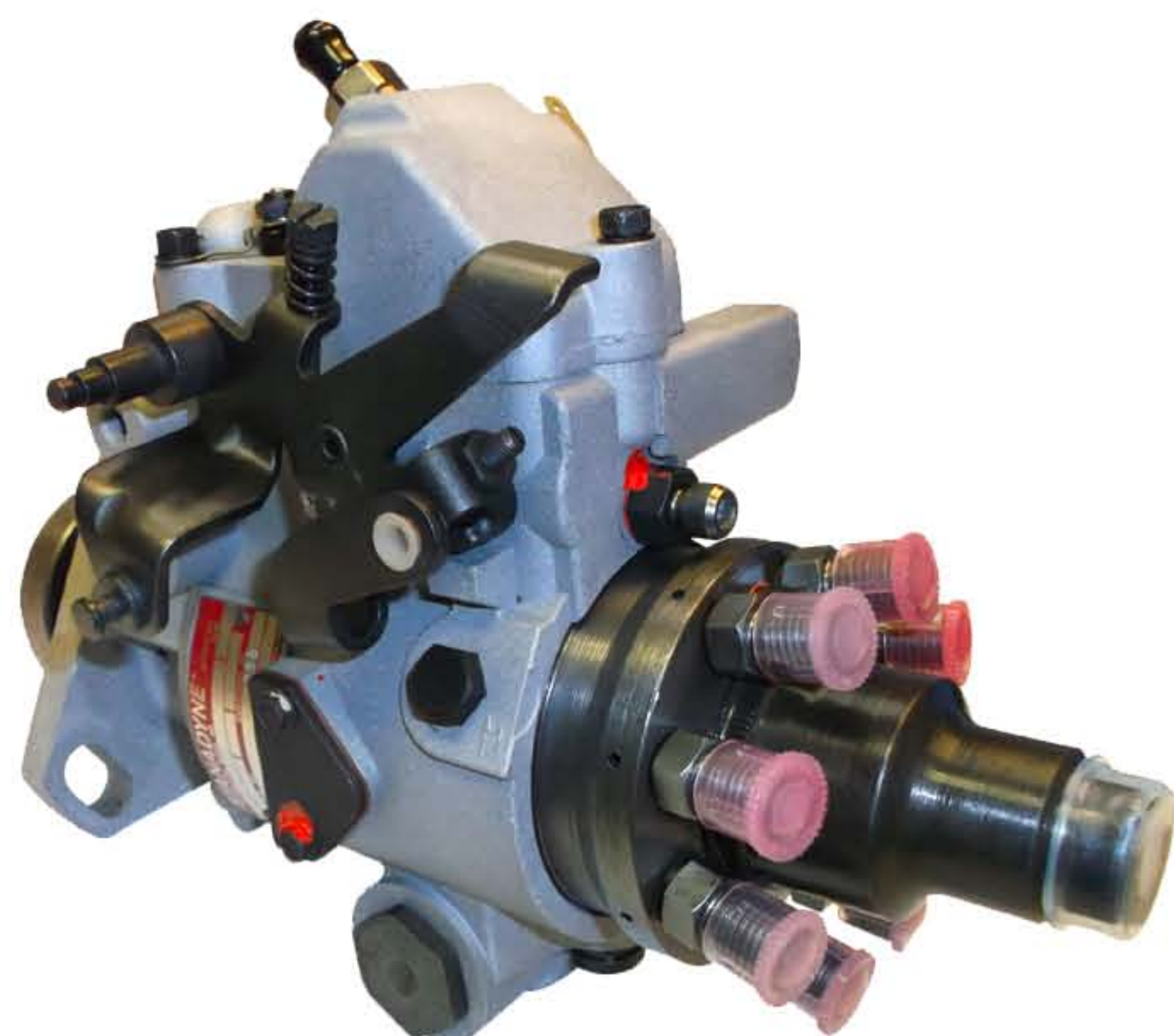

- * 5 Hole Nozzle 325 HP Engine Noted On Valve Cover
- ** 8 Hole Nozzle 305 HP Engine Noted On Valve Cover
- (2): Injector Supply Tube 5.9L # 5086874AB
- (3): Injector Supply Tube 6.7. # 68005335AA
- (4): Injector Line Set Duramax LB7 # 97188720-8
- (5): Valve Cover Gasket Kit #97188896 (2 Required)
- (6): Banjo Return Seals #97228933

300 WEST BROAD STREET, HEMINGWAY, SC 29554

BOSTECHFUEL.COM